

BASEMENT PLAN

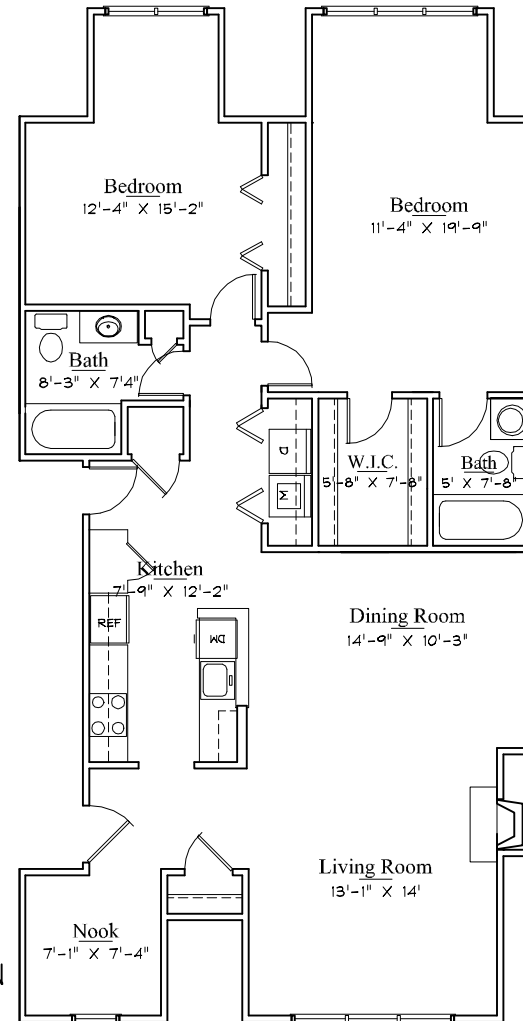

THIRD FLOOR PLAN

UNIT 14F 1,866 SQ. FT.

WASHINGTON PLACE CONDOMINIUM
703 WASHINGTON STREET
CANTON, MA 02021

SEPTEMBER 26, 2007

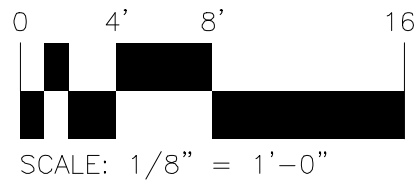

M.Z.O. Architectural Group, Inc.
92 Montvale Avenue, Stoneham, MA. 02180 (781) 279-4446